

## PUBLIC PATH DIVERSION ORDER

### TOWN AND COUNTRY PLANNING ACT 1990: SECTION 257

#### The Stroud District Council Footpath EEA17 Great Oldbury Drive, Stonehouse

#### Section 257 Diversion Order 2023

This order is made by Stroud District Council under section 257 of the Town and Country Planning Act 1990 because it is satisfied that it is necessary to divert the footpath to which this order relates in order to enable development to be carried out in accordance with planning permission granted under Part III of the Town and Country Planning Act 1990 namely the construction of a community hall and changing room facilities, equipped play area (NEAP) associated access and car/cycle parking facilities at land west of Parcel H13 Great Oldbury Drive, Great Oldbury, Gloucestershire (planning reference: S23/0458/REM).

1. **IN THIS ORDER** the following expressions shall have the following meanings attributed to them:
  - 1.1 “**Applicant**” means Robert Hitchins Limited of The Manor, Boddington, Cheltenham, Gloucestershire who has applied for this Order to be made;
  - 1.2 “**Certificate of Completion**” means confirmation in writing provided by the Highway Authority certifying that it is satisfied that the Works have been properly carried out at the cost of the Applicant;
  - 1.3 “**Consent**” means the planning permission granted on the 13<sup>th</sup> July 2023 in respect of reference number S23/0458/REM for the carrying out of the Development;
  - 1.4 “**Development**” means the construction of community hall and changing room facilities, equipped play area (NEAP) associated access and car/cycle parking facilities at Parcel H13, Great Oldbury, Gloucestershire.
  - 1.5 “**Footpath**” means public footpath, Footpath EEA17;
  - 1.6 “**Highway Authority**” means Gloucestershire County Council of Shire Hall, Westgate Street, Gloucester GL1 2TG
  - 1.7 “**New Route**” means the route shown by a broken black line between points A, C and B as marked on the attached plan and described in Part II of the Schedule to this Order;
  - 1.8 “**Original Section**” means that section of the Footpath shown by a solid black line between points A and B as marked on the attached plan and described in Part I of the Schedule to this Order;
  - 1.9 “**Works**” means the works for the purpose of creating a right of way over the New Route as specified in Part III of the Schedule to this Order.

2. **BY THIS ORDER:**

- 2.1 The Original Section shall be diverted as provided for herein;
- 2.2 The New Route shall be created as an alternative public right of way for use as a replacement for the Original Section, subject to the issue of the Certificate of Completion;
- 2.3 The Works shall be carried out at the cost of the Applicant;
- 2.4 The diversion of the Original Section shall take effect from the date of issue of the Certificate of Completion for the Works; and,
- 2.5 Where immediately before the date on which this order comes into effect there is apparatus in, on, over, under, along or across the Original Section belonging to statutory undertakers for the purpose of carrying on their undertaking, those undertakers shall continue to have the same rights in respect of that apparatus as they then had.

3. **THIS ORDER SHALL COME INTO FORCE** on the date of issue of the Certificate of Completion for the Works and may be cited as the "Stroud District Council Footpath EEA17 Great Oldbury, Stonehouse Section 257 Diversion Order 2023".

**SCHEDULE**

**PART I**

Description of site of existing path or way

The length of footpath situated between points A (OS Grid Reference 379082.2, 206623.8) and B (OS Grid Reference 379164.8, 206520.6) marked on the attached plan with a solid black line which measures approximately 136 metres long and of unknown width is to be stopped up in its entirety.

**PART II**

Description of site of alternative highway

The length of footpath shown by a broken black line on the attached plan situated between points A (OS Grid Reference 379082.2, 206623.8), C (OS Grid Reference 379146.4, 206508.8) and B (OS Grid Reference 379164.8, 206520.6) which measures approximately 152 metres in length and approximately 2 metres in width.

**PART III**

Description of the Works

The Footpath is to remain a grass track.

The Order is made this 21<sup>st</sup> day of December 2023

6906.

**THE COMMON SEAL** of the  
**STROUD DISTRICT COUNCIL**

was hereunto affixed in the presence of:

)   
)  
)



Authorised Officer  
Sarah farooqi  
Head of Law, Litigation & Planning



- Key:
- Existing PROW to remain unaltered
  - Existing PROW to be extinguished (136m between points 'A' and 'B')
  - Proposed new PROW route (152m between points 'A', 'C' and 'B')



OS Coordinates:

at point A X= 379082.2 Y= 206623.8  
 at point B X= 379164.8 Y= 206520.6  
 at point C X= 379146.4 Y= 206508.8

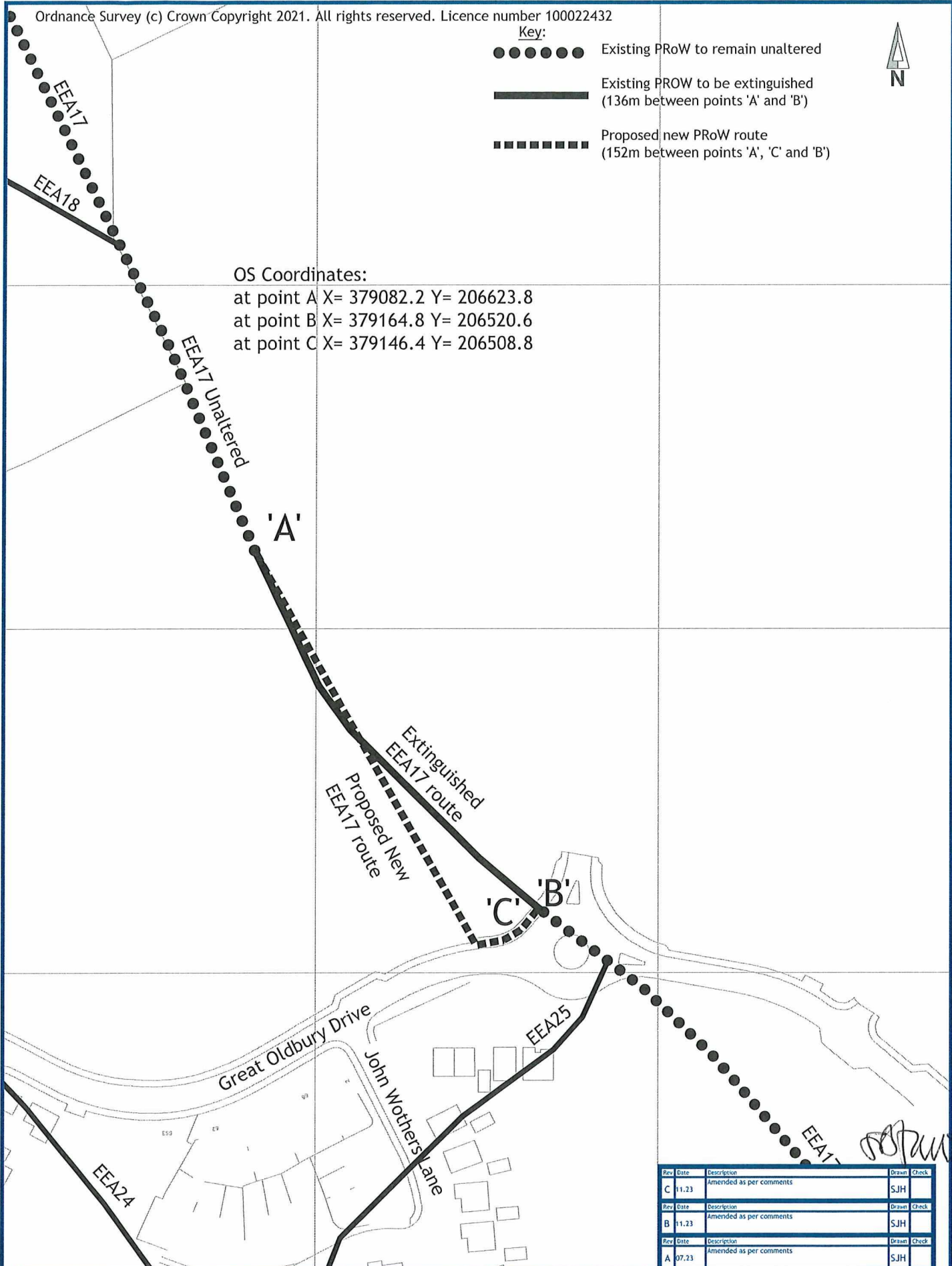

Rev	Date	Description	Drawn	Check
C	11.23	Amended as per comments	SJH	
B	11.23	Amended as per comments	SJH	
A	07.23	Amended as per comments	SJH	

Site Name: Stonehouse Changing Rooms		Drawing Number: STH.CR.PROW.01		Revisions: C	
Drawing Title: PROW Diversion Plan		Drawn By: TGF	Checked By: EJA	Date: 17.04.2023	Scale: 1:1000 @ A3

The Manor, Bodminster, Cheltenham, Gloucestershire, GL51 0TJ  
 Tel: 01242 680914  
 www.robert-hitchens.co.uk

